

RICAMBI  
PIECES  
SPARE PARTS  
ERSATZTEILE  
REPUESTOS

5LD675-3  
5LD825-3  
5LD825-3/L  
5LD930-3

LC  
PAR  
REC  
ML

LON  
FABBI  
REGG  
MAE

SER  
POC  
GAS  
DICI  
SER  
SER  
RICA  
PIEC  
MAE  
WAI  
REPU

SERI  
POCI  
GASI  
DICH  
SERIE  
RICA  
PIECE  
MAIN  
WART  
REPUI

**LOMBARDINI**  
FABBRICA ITALIANA MOTORI S.p.A.  
REGGIO EMILIA, ITALIA  
**MADE IN ITALY**

SERIE GUARNIZIONI  
POCHETTE JOINTS  
GASKET SET  
DICHTUNGSATZ  
SERIE JUNTAS

RICAMBI PRIMO IMPIEGO  
PIECES POUR L'ENTRETIEN  
MAINTENANCE SPARE PARTS  
WARTUNG - ERSATZTEILE  
REPUESTOS DE PRONTO EMPLEO

REPUESTOS ORIGINALES  
ORIGINAL ERSATZTEILE  
GENUINE SPARE PARTS  
PIECES D'ORIGINE  
RICAMBI ORIGINALI

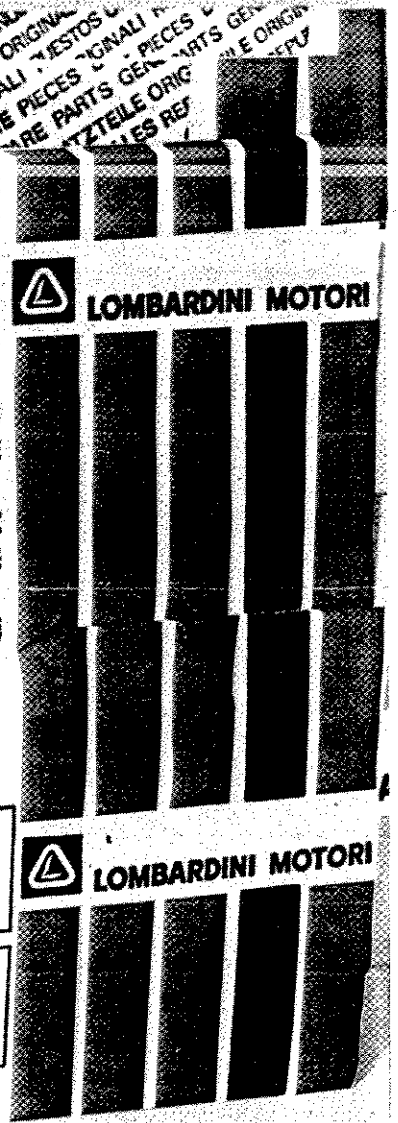
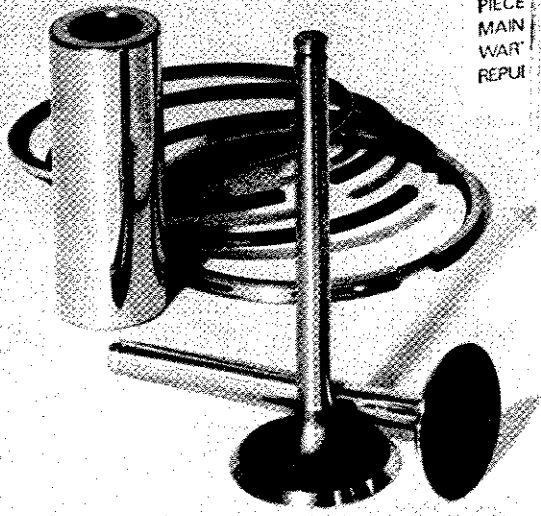

**RICAMBI  
PIECES  
SPARE PARTS  
ERSATZTEILE  
REPUESTOS**

**RICAMBI PER MOTORE STANDARD.  
PER APPLICAZIONI SPECIALI CONSULTARE  
IL CATALOGO PRESSO I CENTRI ASSISTENZA  
E RICAMBI.**

**PIECES POUR DES MOTEURS STANDARD.  
POUR LES ADAPTATIONS CONSULTER  
LE CATALOGUE AUPRES  
DES AGENTS SERVICE.**

**SPARE PARTS FOR STAN  
FOR SPECIAL APPLICATI  
CATALOG AT SERVICE CI**

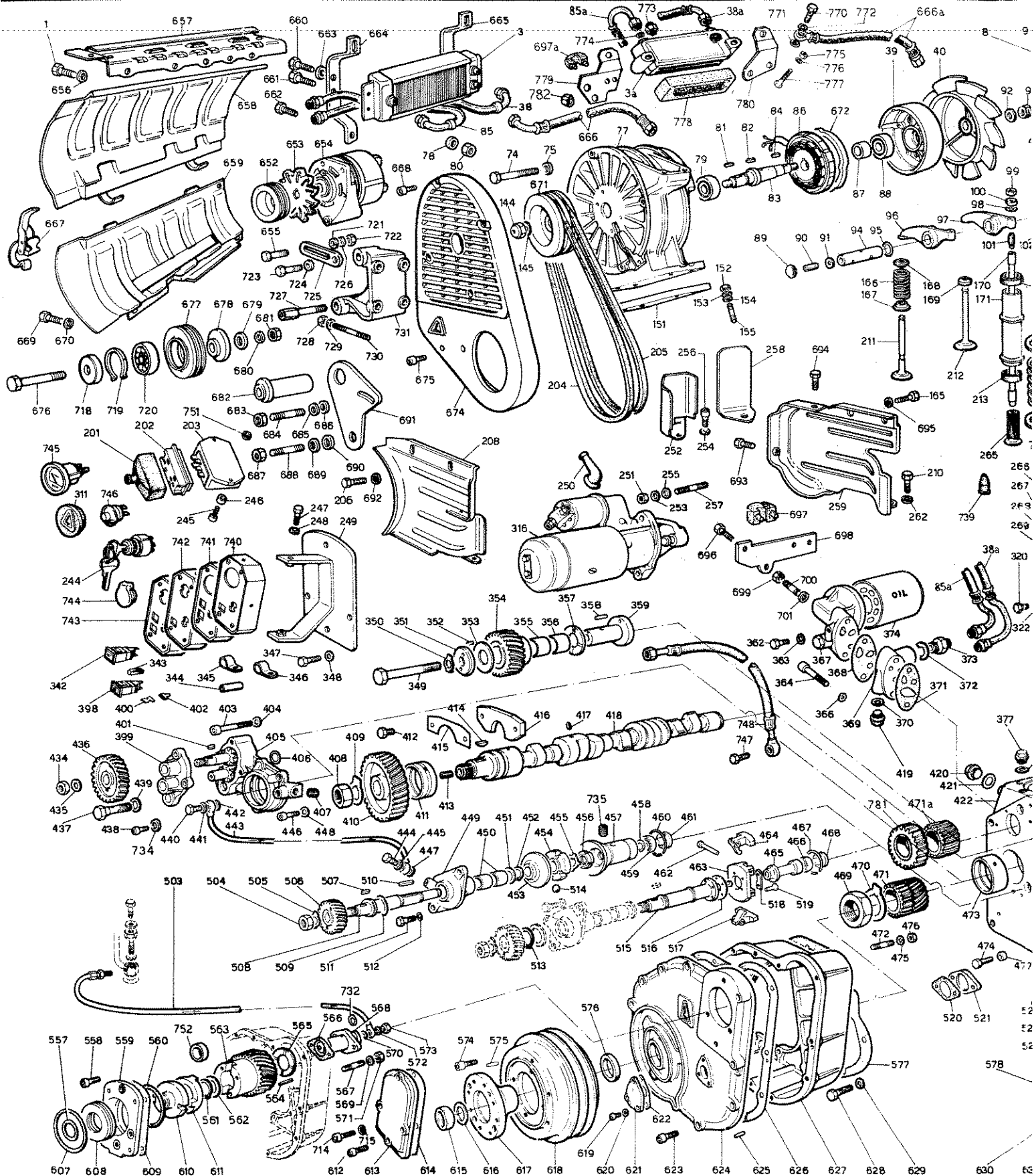

STANDARD ENGINE.  
PARTS SEE MASTER  
CENTERS.

ERSATZTEILE FÜR STANDARD-MOTOREN.  
FÜR SONDERANFERTIGUNGEN SIEHE  
ERSATZTEILKATALOG BEI SERVICE  
WERKSTÄTTEN.

REPUESTOS PARA MOTORES STANDARD.  
PARA APLICACIONES VEASE CATALOGO  
EN LAS ESTACIONES SERVICE.

GRUPPO

5

5LD675-3  
5LD825-3  
5LD825-3/L  
5LD930-3

Matricola 1-5302-08

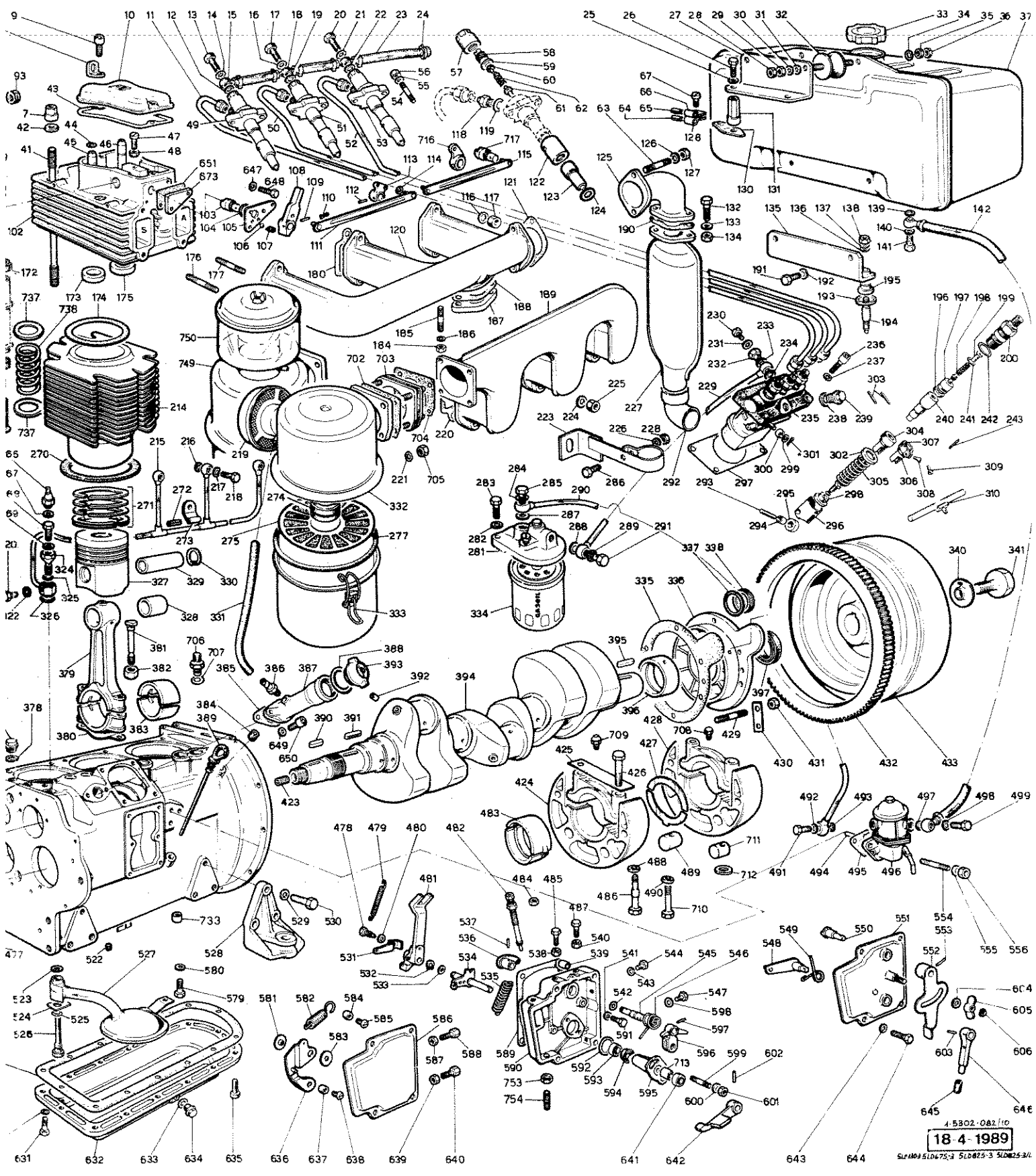

1-5302-082/10  
18-4-1989

5LD675-3 5LD825-3 5LD825-3/L

**SERVICE**

Per assistenza e ricambi rivolgersi a stazioni di servizio autorizzate Lombardini. N. tel. su libretto service e su pagine gialle.  
 Pour toute exigence de service après vente et pièces détachées, s'adresser aux Stations de service du réseau Lombardini. N. de téléphone indiqué sur brochure relative au service après vente et annuaire catégorique.  
 For spare parts and after sale assistance contact authorized Lombardini service centers. Tel. No. appears on service booklet and telephone directory.  
 Für Service und Ersatzteile bitten wir, sich an autorisierte Werkstätte zu wenden. Telef. Nummer laut unserem Service - Büchlein und Fernsprechbuch.  
 Para asistencia y repuestos, dirigirse a las estaciones de servicio autorizadas Lombardini. N. Tel. su libretto service y su hojas amarillas.



**ORDINI RICAMBI**  
**COMMANDES PIÈCES**  
**PART ORDERS**  
**E-TEIL BESTELLUNGEN**  
**PEDIDOS DE REPUESTOS**

**TIPO MOTORE**  
**TYPE DE MOTEUR**  
**ENGINE TYPE**  
**MOTORTYP**  
**TIPO DEL MOTOR**

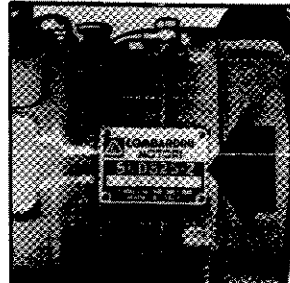
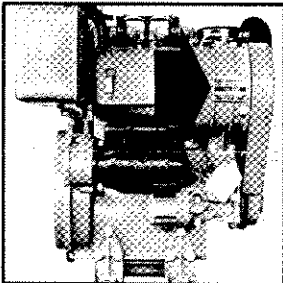

**MATRICOLA**  
**MATRICULE**  
**SERIAL NUMBER**  
**MOTORENNUMMER**  
**NUMERO DEL MOTOR**

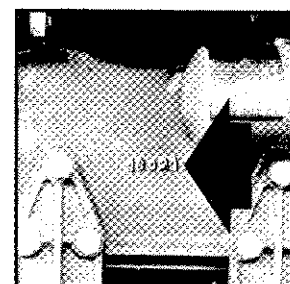
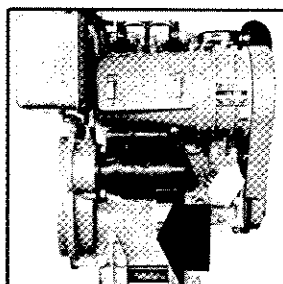
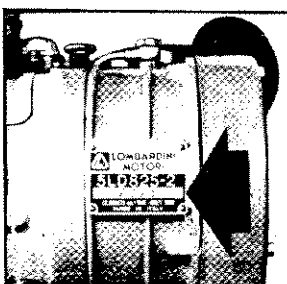
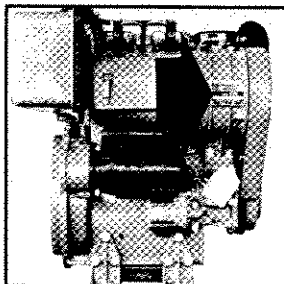

**TIPO DELLA MACCHINA**  
**TYPE DE MACHINE**  
**EQUIPMENT TYPE**  
**MASCHINENTYP**  
**MODELO DE LA MAQUINA**

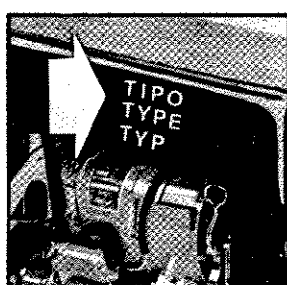
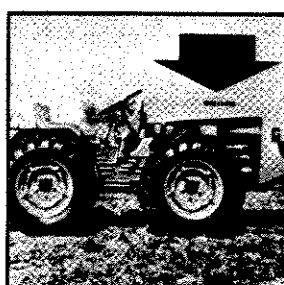

**MATRICOLA del ricambio**  
**REFERENCE de la pièce**  
**SPARE PART number**  
**BESTELLNUMMER des Teiles**  
**REFERENCIA del repuesto**

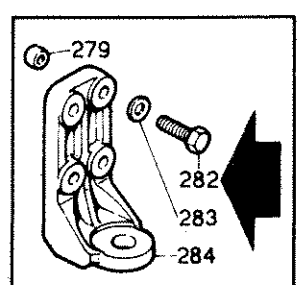
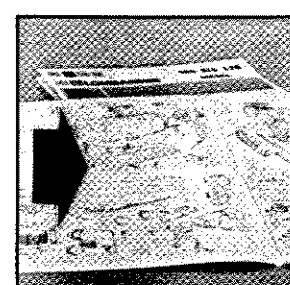

**LOMBARDINI**

FABBRICA ITALIANA MOTORI S.p.A.  
 42100 REGGIO EMILIA, ITALIA - CAS. POST. 105 - Tel. (0522) 58.011 - Teleg. LOMBARMOTOR - Télex 530003 MOTLOM I

B&S LOMBARDINI DIESEL INC. 3402 Oakcreek Road B-2 Doraville, GA. 30540, USA  
 LOMBARDINI FRANCE Zone Industrielle Nord Arnas - Villafranche St/Saône - France  
 LOMBARDINI MOTOREN Gertler Str. 11 - 6 Frankfurt/Main 56, Deutschland  
 LOMBARDINI MOTORES Zona Cova Solera - Rubí/Barcelona, España

Matricola 1-5302-082

Mod. 50232/4  
 18-04-1988  
 Subject to alteration  
 Printed in Italy

-----  
 LEGENDA ..... TAVOLA RICAMBI ..... MATR.  
                   SPARE PARTS TABLE ..... P.NO. ... 1.5302.082  
                   TABLEAU PIECES DETACHEES ..... REF. ....

\*\*\*\*\*  
 15.03.1989  
 \*\*\*\*\*

MOTORI TIPO/ENGINES TYPE/MOTEURS TYPE

5LD 675-3 (R.p.m. 3000)

5LD 824-3 (R.p.m. 2600)	5LD 824-3/B (R.p.m. 3000)
5LD 825-3 (R.p.m. 2600)	5LD 825-3/L (R.p.m. 1500-1800-2200)
5LD 930-3 (R.p.m. 2600)	5LD 930-3/L (R.p.m. 1500-1800)

Vedi/See/Voir

Libretto Uso e Manutenzione	
Use-Maintenance booklet	..... 1.5302.152
Livret Emploi-Entretien	
Libretto Service	
Service directory	..... 1.7968.002
Reseau S.A.V.	
Serie accessori	
Accessory set	..... 2830.8140.081
Jeu accessoires	

Note/Remarks/Remarques

F - alta movimentazione/fast moving part/haut mouvement.  
 S - media movimentazione/medium moving part/moyen mouvement.  
 D - bassa movimentazione/slow moving part/bas mouvement.  
 E - ad esaurimento/exhausting part/piece en epuisement.  
 N - particolare nuovo o fornito su richiesta/  
     -new part or part supplied upon request/  
     -piece nouvelle ou fournie sur demande.  
 A - valido dal motore.../from eng.S.No.../{ partir du moteur...  
     (vedi Circolare Tecnica/see Service Letter/voir Circ.Techn.)  
 B - valido fino al motore.../up to eng.S.No.../jusqu'au moteur...  
     (vedi Circolare Tecnica/see Service Letter/voir Circ.Techn.)  
 I - intercambiabile/interchangeable.  
     (vedi Circolare Tecnica/see Service Letter/voir Circ.Techn.)  
 V - stock vitale per Officine Service.  
     vital stock for Service Dealer.  
     stock vital pour Stations Service.  
 C - stock vitale per Costruttori,Esportatori,Enti di Stato.  
     vital stock for Producers,Exporters,State Companies.  
     stock vital pour Constructeurs,Export.,Institut.de l'Etat.  
 R - stock vitale per Rettifica.  
     vital stock for Grinding Workshops.  
     stock vital pour Usines de Rectification.  
 10/50/2-q.ta minima fornibile/min.supplied q.ty/q.te min.fournie.  
 = gruppo completo/assembly/groupe complet.  
 + componente del gruppo/assembly component/composant du groupe.

-----  
 Serie guarnizioni/Gasket set ..673.8180.067 x 5LD675-3  
   823.8180.064 x 5LD825-3 5LD825-3/L  
   933.8180.069 x 5LD930-3  
 Serie anelli/O.ring set .....830.8150.009 - 672.8150.011  
 Serie lamierini/Lock.set .....830.8190.011

TIPO MOTORE/ENGINE TYPE	BLOCCO MOTORE/SHORT BLOCK
5LD 675-3	6730.1560.075
5LD 825-3 - 5LD 825-3/L	8230.1560.076
5LD 930-3	9330.1560.078

TECO/ATL/Assistenza Tecnica Lombardini

DESCRIZIONI NON IMPEGNATIVE  
 SUBJECT TO MODIFICATIONS

FIG. NO.	MATRICOLA PART NO.	Q.ta Q.ty	NOTE REMARKS	Gr. 5-3 Cyl. Pag.02
1	9.1760.001 FV	10	1	bullone/bolt M 6 X 1 X 10
3	823.7350.013 S BC		1	radiatore olio/oil cooler
3a	823.7350.034 N A		1	" "
7	276.3206.016 FV C	10	12	dado/nut
8+	904.8506.003 S AC	10	3	squadretta/angle bracket
9+	9.9732.064 S	10	6	vite/screw M 8 X 1,25 X 30
10+8+9= =276.2125.081 S IC			3	CAPPELLO SCATOLA BILANCIERI ROCKER BOX CAP
11	277.9372.018 SV C		1	tubo mandata/delivery pipe
12	9.4670.058 FV C	10	1	guarnizione/copper gasket
13	9.1901.029 FVIC	10	1	bullone raccordo/connection bolt
14	9.4670.058 FV C	10	1	guarnizione/copper gasket
15	9.7270.102 N	10	1	raccordo/connection
16	9.4670.058 FV C	10	1	guarnizione/copper gasket
17	9.1901.029 FVIC	10	1	bullone raccordo/connection bolt
18	9.7270.101 N	10	1	raccordo/connection
19	9.4670.058 FV C	10	1	guarnizione/copper gasket
20	9.1901.029 FVIC	10	1	bullone raccordo/connection bolt
21	9.4670.058 FV C	10	1	guarnizione/copper gasket
22	9.4670.058 FV C	10	1	guarnizione/copper gasket
23	277.9571.015 FV C		1	tubo spurgo/bleeding pipe
24	9.3630.004 F C	10	6	fascetta/clamp
25	9.7565.013 S C	10	2	rondella/washer
26	9.1790.027 D C	10	2	bullone/bolt M 12 X 1,25 X 20
27	2760.8865.091 D C		1	supporto serbatoio/tank support
28	9.3240.020 SV C	10	2	dado/nut
29	9.3240.018 FV	10	2	dado/nut
30	9.7565.007 F C	10	2	rondella/washer
31	9.7625.012 FV C	10	2	rondella/washer
32	9.8635.059 FV C		2	supporto antivib./vibration isolator
33+	276.9043.015 FV C		1	tappo serbatoio/fuel tank cap
34	9.7565.007 F C	10	2	rondella/washer
35	9.3240.018 FV	10	2	dado/nut
36	9.3240.020 SV C	10	2	dado/nut
37+33= =276.8101.032 S C			1	SERBATOIO COMPLETO FUEL FILTER
38	823.9485.067 SVBC		1	tubo olio/oil pipe
38a	823.9485.096 N A		1	" "
39	276.2086.061 S A		1	campana/bell alternat. 12 V-21 A
"	276.2086.066 S A		1	" " 12 V-14 A
40	823.9718.077 S C		1	ventola/blaster fan
41	276.6850.065 S C		12	prigioniero/stud 5LD675-3
"	832.6850.082 S C		12	" " 5LD825-3 -825-3/L -930-3
42	9.7625.197 N	10	12	rondella/washer
43+	276.4680.040 FV C	50	3	guarnizione/gasket 0,50
44+	276.1160.004 FV C	10	6	anello/circlip
45+	276.4845.041 E		3	guida v.scar./exh.v.guide +0,50
"	276.4845.164 FVICR10		3	" " std.
"	276.4845.165 FVICR10		3	" " +0,50
46+	276.4845.040 E		3	guida v.asp./inlet v.guide +0,50
"	276.4845.162 FVICR10		3	" " std.
"	276.4845.163 FVICR10		3	" " +0,50
47+	715.9820.080 S C	10	3	vite/screw
48+	9.3240.008 FV	10	3	dado/nut
49	276.6615.011 F C		1	portapolverizzatore/nozzle holder std.
"	276.6615.029 S C		1	" " Bosch
50	276.9372.007 FV C		1	tubo mandata/delivery pipe
51	276.6615.011 F C		1	portapolverizzatore/nozzle holder std.
"	276.6615.029 S C		1	" " Bosch
52	276.9372.006 FV C		1	tubo mandata/delivery pipe
53	276.6615.011 F C		1	portapolverizzatore/nozzle holder std.
"	276.6615.029 S C		1	" " Bosch
54+	9.6780.057 FV C	10	6	prigioniero/stud M 8 X 30 (45)
55	9.7565.007 F C	10	6	rondella/washer
56	9.3240.018 FV	10	6	dado/nut
57	260.4130.053 SV C		3	ghiera/ring nut
58	260.1570.016 DV C		3	bocchettone/filler
59	260.4370.007 DV C	10	3	guarnizione/gasket
60	260.8010.002 DV C		3	sede/seat
61	260.1420.012 DV C		3	asta comando/control rod
62	260.5800.038 SV C		3	molla/spring
63	9.6780.008 FV C	10	2	prigioniero/stud M 8 X 20 (32)
64	276.5400.046 F C	10	2	manicotto/rubber sheating
65	276.5400.046 F C	10	1	manicotto/rubber sheating
66	276.3616.018 S C	10	2	fascetta/strip fixing
67	9.9790.011 D C	10	2	vite/screw M 5 X 0,8 X 14
74	9.1760.068 S C	10	4	bullone/bolt M 6 X 1 X 90
75	9.7565.004 F C	10	4	rondella/washer

FIG. NO.	MATRICOLA PART NO.	Q.ta Q.ty	NOTE REMARKS	Gr. 5-3 Cyl. Pag. 03
77	823.8565.034 S C	1	statore/stator	
78	9.7565.007 F BC 10	4	rondella/washer	
79	9.3003.052 SV C	1	cuscinetto/ball bearing	
80	9.3240.018 FVB 10	4	dado/nut	
81	9.2200.004 FV C 10	1	chiavetta/key	
82	9.2200.004 FV C 10	1	chiavetta solo per soffiante con altern.	
			key for fan with alternator only	
83	823.1105.016 F C	1	albero ventola/fan spindle	
84	9.2200.004 FV C 10	1	chiavetta/key	
85	823.9485.068 S BC	1	tubo olio/oil pipe	
85a	823.9485.092 N A	1	" "	
86	822.1157.158 FVIC	1	alternatore/voltage alternator 12 V-14 A	
"	822.1157.159 FVIC	1	" " 12 V-21 A	
87	823.3450.047 D 10	1	distanziale/spacer altern. 12 V-14 A	
"	823.3450.049 S C 10	1	" " 12 V 21 A	
"	823.3450.048 S C 10	1	distanziale per soffiante senza altern.	
			spacer for fan without alternator only	
88	9.3003.047 FV C	1	cuscinetto/ball bearing	
89+	9.8990.011 F C 10	3	tappo/plug	
90+	9.9730.008 D C 10	3	vite/screw M 6 X 1 X 10	
91+	9.4670.062 FVIC 10	3	guarnizione/copper gasket	
92	9.7625.055 SV C 10	1	rondella/washer	
93	9.3203.015 FV C 10	1	dado/nut	
94+	276.6045.022 FV C	3	perno bilancieri/rocker arm shaft	
95+	9.1200.030 FV C 10	3	anello OR/rubber oil seal	
	96+47+48+90+91+94+		GRUPPO BILANC.COMPLETO	
	95+97+98+99+100+101=		ROCKER ARM ASS.Y	
	=276.4330.019 F C	3		
97+	.....		vedi/see fig.No. 96+...	
98+	276.8335.028 S C 10	9	spessore/shim	
"	276.8335.084 N	3	" "	
99+	9.3240.010 FV C 10	6	dado/nut	
100+	276.2135.052 SV C 10	3	cappellotto/cap	
101+	276.9850.045 S C	6	vite/screw	
	102+44+45+46+47+48+		TESTA COMPLETA	
	54+89+90+91+94+95+		CYLINDER HEAD	
	96+97+98+99+100+101+			
	166+167+168+169+173+			
	175+176+177+211+212+			
	647+648+651+673=			
	=672.9200.135 S C	3	x 5LD675-3	
	=822.9200.137 S C	3	x 5LD825-3 - 825-3/L - 930-3	
	102+44+45+46+54+89+		TESTA CON SEDI E GUIDE	
	173+175+176+177+647+		CYL.HEAD WITH SEATS AND GUIDES	
	648+651+673=			
	=672.9200.136 S C	3	x 5LD675-3	
	=822.9200.138 S C	3	x 5LD825-3 - 825-3/L - 930-3	
103+	276.6095.007 F C	2	perno decompressione/decompression pin	
104+	9.1200.040 FV C 10	3	anello OR/rubber oil seal	
105+	276.6370.082 S C	3	piastra/plate	
106+	9.8245.004 F C 10	1	sfera/ball	
107+	276.5695.002 FV C 10	1	molla/spring	
	108+103+104+105+106+		DECOMPRESSIONE COMPLETA	
	107+109+110+111+112+		DECOMPRESSION ASS.Y	
	113+114+115+716+717=			
	=8230.4873.009 S C	1		
108+	276.5203.081 F C	1	leva/lever	
109+	9.8430.034 S IC 10	1	spina/locating pin	
110+	9.2800.003 F C 10	4	copiglia/cotter pin	
111+	276.9245.040 S C 10	1	tirante/tie rod	
112+	9.8430.034 S IC 10	2	spina/locating pin	
113+	276.5203.082 F C	1	leva/lever	
114+	9.7625.005 FV C 10	4	rondella/washer	
115+	277.9245.071 D	1	tirante/tie rod	
116	9.7565.007 F C 10	6	rondella/washer	
117	9.3240.019 FV C 10	6	dado/nut	
118	500.7301.006 D I	3	raccordo/connection	
119	260.4650.037 DV C 10	3	guarnizione/gasket	
120	277.2485.035 F C	1	collettore scar./exhaust manifold std.	
"	2770.2486.013 S	1	" " prolungato/extended	
121+	276.4500.079 FV C 10	1	guarnizione/gasket	
122	276.4130.062 SV C	3	ghiera/ring nut	
123	276.6531.010 FVIC	3	polverizzatore/nozzle std.	

FIG. NO.	MATRICOLA PART NO.	Q.ta Q.ty	NOTE REMARKS	Gr. 5-3 Cyl. Pag. 04
124	9.4670.009 FV C 10	3	guarnizione/copper gasket	0,50
"	9.4670.010 FV C 10	3	"	1,00
"	9.4670.011 FV C 10	3	"	1,50
125	2760.2940.087 F C	1	curva scarico/exhaust elbow	
126	9.7565.007 F C 10	2	rondella/washer	
127	9.3240.019 FV C 10	2	dado/nut	
128	276.3616.018 S C 10	1	fascetta/strip fixing	
130	276.8545.031 D C	2	staffa/brace	
131	276.3206.045 SVIC 10	2	dado/nut	
132	9.1770.006 S	10	bullone/bolt M 8 X 1,25 X 25	
133	9.7565.007 F C 10	2	rondella/washer	
134	9.3240.019 FV C 10	2	dado/nut	
135	2760.8865.090 D C	1	supporto serb./tank support	5LD675-3
"	8320.8866.002 D C	1	"	5LD825-3 -825-3/L -930-3
136	9.7565.007 F C 10	2	rondella/washer	
137	9.7625.012 FV C 10	2	rondella/washer	
138	9.3240.020 SV C 10	2	dado/nut	
139	9.4670.059 FVIC 10	1	guarnizione/copper gasket	
140	9.4670.059 FVIC 10	1	guarnizione/copper gasket	
141	9.1901.045 FVIC 10	1	bullone raccordo/connection bolt	
142	276.9372.003 SV C 10	1	tubo combustibile/fuel pipe	
144	9.3203.015 FV C 10	1	dado/nut	
145	9.7625.055 SV C 10	1	rondella/washer	
151	.....			
152	9.3240.033 FV 10	4	dado/nut	
153	9.7625.019 S 10	4	rondella/washer	
154	9.7565.011 F C 10	4	rondella/washer	
155+	9.6800.010 S C 10	4	prigioniero/stud M 10 X 25 (40)	
165	9.1760.003 F 10	2	bullone/bolt M 6 X 1 X 12	
166+	276.5755.040 FV C 10	6	molla/spring	
167+	276.6410.020 F C 10	6	piattello/cup	
168+	276.6410.023 F C 10	6	piattello/retainer with half-collets	
169+	276.2135.063 FV C 10	3	cappello/cap	
170	276.1410.028 SVIC 10	6	asta punt./push rod	5LD675-3
"	832.1410.029 FVIC	6	"	5LD825-3 -825-3/L -930-3
171	276.9520.028 FVBC	6	tubo prot./guard tube	5LD675-3
"	672.9520.049 FVAC	6	"	"
"	832.9520.032 FVBC	6	"	5LD825-3 -825-3/L -930-3
"	822.9520.050 FVAC	6	"	"
172	276.1261.046 FVBC 10	6	anello tenuta/seal ring	
"	672.1261.069 FVAC 10	6	"	"
173+	672.8000.075 FV CR 10	3	sede v. scar./exh.v.seat	5LD675-3
"	822.8000.073 FV CR 10	3	"	5LD825-3 -825-3/L -930-3
174+	672.4730.096 SV C 10	3	0,70 x 5LD675-3	guarn.testa/head gasket
"	672.4730.083 DV C 10	3	0,80	"
"	672.4730.097 DV C 10	3	0,90	"
"	672.4730.098 SV C 10	3	1,00	"
"	672.4730.135 DV C 10	3	1,10	"
"	822.4730.104 SV C 10	3	0,70 x 5LD825-3 - 825-3/L	"
"	832.4730.023 FV C 10	3	0,80	"
"	822.4730.105 DV C 10	3	0,90	"
"	822.4730.094 SV C 10	3	1,00	"
"	822.4730.136 SV C 10	3	1,10	"
"	933.4730.100 FV C 10	3	0,70 x 5LD930-3	"
"	933.4730.101 DV C 10	3	0,80	"
"	933.4730.102 DV C 10	3	0,90	"
"	933.4730.106 DV C 10	3	1,00	"
"	933.4730.137 FV C 10	3	1,10	"
175+	672.8000.074 FV CR 10	3	sede v. asp./inlet v.seat	5LD675-3
"	822.8000.072 FV CR 10	3	"	5LD825-3 -825-3/L -930-3
176+	9.6780.057 FV C 10	6	prigion.scar./exhaust stud M 8 X 30 (45)	
177+	9.6780.049 D C 10	6	prigion.aspir./inlet stud M 8 X 20 (36)	
180+	276.4420.007 FV C 10	3	guarnizione/gasket	
184	9.3240.019 FV C 10	2	dado/nut	
185	9.6780.008 FV C 10	2	prigioniero/stud M 8 X 20 (32)	
186	9.7565.007 F C 10	2	rondella/washer	
187	277.6300.018 S C	1	piastra/plate	
188+	276.4500.079 FV C 10	1	guarnizione/gasket	
189	823.2486.041 S C	1	collettore aspirazione/inlet manifold	
190	276.4500.079 FV C 10	1	guarnizione/gasket	
191	9.1780.003 D	10	bullone/bolt M 10 X 1,5 X 18	
192	9.7565.011 F C 10	2	rondella/washer	
193	276.7980.042 S C 10	2	scodellino/cup	
194	276.6487.004 S C 10	2	piolo/pivot	
195	276.8960.012 FV C 10	2	tampone/buffer	
196	271.4760.015 FV C 10	3	guarnizione/gasket	
197	500.9672.012 F C	3	valvola mandata/delivery valve	
198	271.5755.034 SV C 10	3	molla/spring	
199	271.7470.003 FV C 10	3	riempitore/filler	
200	271.7265.008 FV C 10	3	raccordo/connection	
201	276.2145.014 FVAC	1	cappuccio/rubber cap	



FIG. NO.	MATRICOLA PART NO.	Q.ta Q.ty	NOTE REMARKS	Gr. 5-3 Cy1. Pag.05
202	276.6740.088 FVBC 10	1	presa regol./inlet regul.Saprisa	
"	2830.6740.153 FVAC 10	1	" " " "	
"	276.6740.089 SVBC 10	1	" " " Ducati	
"	276.6740.090 SVBC 10	1	" " " Ducati con spia c.b./with c.b.light	
"	2830.6740.154 FVAC 10	1	" " " " "	
203	2830.7362.238 FVIC 10	1	regolat.tens./voltage regul.12 V-14/21 A	
204	673.2440.089 FV C 2	1	cinghia/belt std. x 5LD675-3	
"	823.2440.088 FV C 2	1	" " " std. x 5LD825-3 - 825-3/L	
"	933.2440.125 FV C 2	1	" " " std. x 5LD930-3	
"	822.2440.114 FV C 1	1	" " " 5LD825-3/L -930-3 (1500-1800/'')	
"	933.2440.139 FV C 2	1	cinghia per motore con alternat.esterno belt for engine with external alternator	
205	673.2440.089 FV C 2	1	cinghia/belt std. x 5LD675-3	
"	823.2440.088 FV C 2	1	" " " std. x 5LD825-3 - 825-3/L	
"	933.2440.125 FV C 2	1	" " " std. x 5LD930-3	
"	822.2440.114 FV C 1	1	" " " 5LD825-3/L -930-3 (1500-1800/'')	
"	933.2440.139 FV C 2	1	cinghia per motore con alternat.esterno belt for engine with external alternator	
206	9.1760.003 F 10	2	bullone/bolt M 6 X 1 X 12	
208	823.5066.041 D C 1	1	lamiera/airtight plate	
210	9.1770.002 FV 10	2	bullone/bolt M 8 X 1,25 X 16	
211+	276.9685.019 FV CR10	3	valvola scar./exh.valve 5LD675-3	
"	822.9685.053 FV CR10	3	" " " 5LD825-3 -825-3/L -930-3	
212+	276.9652.015 FV CR10	3	valvola asp./inlet valve 5LD675-3	
"	822.9652.041 FV CR10	3	" " " 5LD825-3 -825- /L -930-3	
213	276.1261.046 FVBC 10	6	anello tenuta/seal ring	
"	672.1261.069 FVAC 10	6	" " " " "	
214	672.2380.101 FV C 3	3	cilindro/cylinder 5LD675-3	
"	832.2380.085 FV C 3	3	" " " 5LD825-3 - 825-3/L	
"	933.2380.134 FV C 3	3	" " " 5LD930-3	
215	823.9455.062 D C 1	1	tubo lubrificazione/lub.pipe	
216	9.4670.058 FV C 10	3	guarnizione/copper gasket	
217	9.4670.058 FV C 10	3	guarnizione/copper gasket	
218	9.1901.054 FVIC 10	3	bullone raccordo/connection bolt	
219+	276.2135.093 F IC 1	1	cappellotto/air inlet cover	
220+	276.4420.008 FV C 10	3	guarnizione/gasket	
221	9.7555.007 DV C 10	8	rondella/washer	
223	2760.8546.014 F C 1	1	staffa/brace	
224	9.7565.007 F C 10	6	rondella/washer	
225	9.3240.018 FV 10	6	dado/nut	
226	9.7565.011 F C 10	1	rondella/washer	
227	2830.5461.047 F C 1	1	marmitta/muffler	
228	9.3240.033 FV 10	1	dado/nut	
229	823.9375.153 SV C 1	1	tubo da filtro comb. a pompa iniezione pipe from fuel filter to injection pump	
230	9.9080.037 FV C 10	1	tappo/deaeration plug	
231	9.4775.196 SV C 10	1	guarnizione/gasket	
232	9.1901.031 FVIC 10	1	bullone raccordo/connection bolt	
233	9.4670.060 FVIC 10	1	guarnizione/copper gasket	
234	9.4670.060 FVIC 10	1	guarnizione/copper gasket	
235	823.6590.051 F C 1	1	pompa/inject.pump 675-3 -825-3 -825-3/L	
"	823.6590.053 F C 1	1	" " " " " Bosch type	
"	933.6590.058 F C 1	1	" " " 5LD930-3 std.	
"	933.6590.057 F C 1	1	" " " " " Bosch type	
236	9.9730.026 F 10	4	vite/screw M 8 X 1,25 X 20	
237	9.7625.010 FV C 10	4	rondella/washer	
238	277.4650.052 DV C 10	1	guarnizione/gasket	
239	277.9080.035 SV C 10	1	tappo/cap	
240	673.6578.026 FV C 3	3	pompante/plunger 5LD675-3 -825-3 -825-3/L	
"	823.6578.030 FV C 3	3	" " " " " Bosch type	
"	933.6578.028 FV C 3	3	" " " 5LD930-3 std.	
"	933.6578.031 FV C 3	3	" " " " " Bosch type	
241	271.8335.029 SV C 10	3	spessore/shim	
242	9.1200.031 FV C 10	3	anello OR/rubber oil seal	
243	9.8400.048 D 10	1	spina/taper pin	
244	2760.5041.020 FV C 1	1	interruttore/key switch	
245	9.9730.028 F 10	2	vite/screw M 8 X 1,25 X 30	
246	276.3526.010 S 10	2	distanziale/spacer	
247	9.1760.032 S C 10	2	bullone/bolt M 6 X 1 X 14	
248	9.7625.092 D C 10	2	rondella/washer	
249	2760.8902.094 D C 1	1	supporto/support	
250	2830.6491.005 FV C 1	1	pipetta/pipe elbow	
251	9.3240.048 FV C 10	2	dado/nut	
252	276.3350.021 D 2	2	deflettore/deflector 5LD675-3	
253	9.7625.026 S 10	2	rondella/washer	
254	9.7565.007 F C 10	2	rondella/washer	
255	9.7565.013 S C 10	2	rondella/washer	
256	9.9730.024 DV C 10	2	vite/screw M 8 X 1,25 X 16	
257+	9.6820.014 D 10	2	prigioniero/stud M 8 X 30 (48)	
258	832.3350.031 S C 2	2	deflett./deflector 825-3 -825-3/L -930/L	
259	823.5066.042 D C 1	1	lamiera/airtight plate	
262	9.7565.007 F C 10	2	rondella/washer	

FIG. NO.	MATRICOLA PART NO.	Q.ta Q.ty	NOTE REMARKS	Gr. 5-3 Cyl. Pag.06
265	276.7215.028 FV C	6	punteria/tappet	
266+400+739= =9040.6745.031 FVAC		1	PRESSOSTATO COMPLETO OIL PRESSURE SWITCH	
267	276.4670.014 SV C 10	1	guarnizione/copper gasket	
268	9.8965.003 FV C 10	1	tappo/plug	
269	9.4670.007 S 10	1	guarnizione/copper gasket	
270+	822.4410.055 FV C 10	3	guar.cil./gask.0,50 675-3 -825-3 -825-3/L	
"	933.4410.054 FV C 10	3	" " 0,50 -5LD930-3	
271+	276.8210.052 FV C 10	3	std. x 5LD675-3 serie segm./ring set	
"	276.8210.053 F CR10	3	+0,50 " " "	
"	276.8210.054 F CR10	3	+1,00 " " "	
"	832.8210.067 FV C 10	3	std. x 5LD825-3 - 825-3/L	
"	832.8210.068 F CR10	3	+0,50 " " "	
"	832.8210.069 F CR10	3	+1,00 " " "	
"	933.8211.014 FV C 10	3	std. x 5LD930-3	
"	933.8211.015 F CR10	3	+0,50 " " "	
"	933.8211.016 F CR10	3	+1,00 " " "	
272	2760.5400.093 N 10	2	manicotto/rubber sheating	
273	2760.3617.023 D C 10	2	fascetta/strip fixing	
274+	9.1261.056 FV C 10	1	anello tenuta/seal ring	
275+	276.5496.074 FV C	1	massa filtrante/filtering element	
277+	276.4776.029 S C 10	1	guarnizione/gasket	
281+334= =823.3730.038 SV C		1	FILTRO COMBUSTIBILE COMPLETO FUEL FILTER	
282	9.7555.008 FV C 10	2	rondella/washer	
283	9.1780.005 FV 10	2	bullone/bolt M 10 X 1,5 X 28	
284	9.4670.061 FVIC 10	1	guarnizione/copper gasket	
285	9.1901.032 FVIC 10	1	bullone raccordo/connection bolt	
286	9.1780.031 FV 10	1	bullone/bolt M 10 X 1,5 X 25	
287	9.4670.061 FVIC 10	1	guarnizione/copper gasket	
288	9.4670.061 FVIC 10	1	guarnizione/copper gasket	
289	9.4670.061 FVIC 10	1	guarnizione/copper gasket	
290	823.9375.183 S	1	tubo da pompa alim. a filtro combust. pipe from feed pump to fuel filter	
291	9.1901.032 FVIC 10	1	bullone raccordo/connection bolt	
292	2910.9170.028 F C	1	terminale/muffler-end	
293	260.6230.068 SV C	3	perno/pin	
294	260.1970.054 DV C	3	bussola/sleeve	
295	260.7770.020 SV C	3	rullo/roller	
296	260.7215.017 FV C	3	punteria/tappet	
297+	277.4580.020 D C 50	4	guarnizione/gasket 0,10	
"	277.4580.021 N 50	2	" " 0,50	
"	673.4580.069 N 50	1	" " 0,05	
298	260.6400.024 D	3	piattello/retainer	
299	9.7626.017 N 10	1	rondella/washer	
300	276.1580.023 F C 10	1	boccola/bushing	
301	9.2800.003 F C 10	1	copiglia/cotter pin	
302	260.7980.020 SV C	3	scodellino/cup	
303	277.6230.075 SV C 10	2	perno/pin	
304	260.4850.009 FV C	2	guida/guide	
305	260.5625.002 SV C	3	molla/spring	
306	261.1970.055 DV C	1	bussola/sleeve	
307	261.8235.014 SV C	1	settore/sector	
308	261.9865.040 DV C	1	vite/screw	
309	260.6230.069 DV C	3	perno/pin	
310	277.1415.009 DVAC	1	asta comando/control rod	
311	9040.2615.021 F C	1	coperchio/cover	
316	278.5840.067 F I	1	mot.avv./start.engine HP 2,5 Bosch type	
320	276.9065.005 N 10	1	tappo/plug	
322	9.4670.060 FVIC 10	1	guarnizione/copper gasket	
324	822.7330.128 SV C	1	raccordo/connection	
325	9.4670.060 FVIC 10	1	guarnizione/copper gasket	
326	9.1200.038 FV C 10	1	anello OR/rubber oil seal	
327+271+329+330= =672.6500.153 FV C		3	PISTONE COMPLETO/PISTON SET	
=672.6500.156 F CR		3	std. x 5LD675-3	
=672.6500.157 F CR		3	+0,50 " " "	
=822.6500.664 FVIC		3	+1,00 " " "	
=822.6500.155 F CR		3	std. x 5LD825-3 - 825-3/L	
=822.6500.158 F CR		3	+0,50 " " "	
=933.6500.159 FV C		3	+1,00 " " "	
=933.6500.160 F CR		3	std. x 5LD930-3	
=933.6500.161 F CR		3	+0,50 " " "	
			+1,00 " " "	
328+	270.1630.006 FV CR10	3	br.piede biella/small end bear. 5LD675-3	
"	832.1630.011 FV CR	3	" " 5LD825-3 -825-3/L -930-3	

FIG. NO.	MATRICOLA PART NO.	Q.ta Q.ty	NOTE REMARKS	Gr. 5-3 Cy1. Pag. 07
329+	279.8480.021 S C	3	spinotto/gudgeon pin	5LD675-3
"	832.8480.027 S C	3	"	5LD825-3 -825-3/L -930-3
330+	9.1240.026 FV C 10	6	anello seeger/snap ring	5L675-3
"	9.1240.031 FV C 10	6	"	5LD825-3 -825-3/L -930-3
331	822.9400.056 S C	1	tubo depressione/suction line	
332+219+274+275+277+ 333=	=822.3703.047 SV C	1	FILTRO ARIA CON CAPPELLOTTO AIRCLEANER WITH AIR INLET COVER	
333+	276.4115.048 F C 10	2	gancio/hook	
334+	276.2175.046 FVAC	1	cartuccia comb./fuel filter element	
335+	276.4701.013 S C 50	1	guarnizione/gasket	
336+397+708=	=822.8676.095 S C	1	SUPP.L.VOLANO/FLYWHEEL SIDE SUPP. x 5LD675-3	
336+397+709=	=824.8676.094 S C	1	SUPP.L.VOLANO/FLYWHEEL SIDE SUPP. x 5LD825-3 - 825-3/L - 930-3	
337+	9.1200.036 FV C 10	1	anello OR/rubber oil seal	
338+	276.2710.039 S C 10	1	coperchio/cover	
340	276.5111.005 F C 10	1	lamierino/tabwasher	
341	276.1861.045 S C	1	bullone/bolt	
342	9040.6612.063 S AC	1	spia olio/pressure oil warning	
343	9040.5175.119 F AC 10	2	lampadina/lamp	
344	2760.5400.093 N 10	2	manicotto/rubber sheating	
345	5000.3617.021 D 10	1	fascetta/strip fixing	
346	2760.3617.020 S C 10	1	fascetta/strip fixing	
347	9.1770.004 F C 10	4	bullone/bolt M 8 X 1,25 X 20	
348	9.7565.007 F C 10	4	rondella/washer	
349	9.1861.044 D C 10	1	bullone/bolt	
350	276.5111.003 S C 10	1	lamierino/tabwasher	
351	276.7670.084 N 10	1	rondella/molla	
352	9.8430.036 D C 10	1	spina/locking needle	
353	276.3495.040 S C 10	1	distanziale/spacer	
354+355+356=	=276.4935.048 F C	1	INGRANAGGIO INTERMEDIO INTERMEDIATE GEARWHEEL	
355+	276.1685.024 SV C	1	bronzina/bearing	
356+	276.1685.024 SV C	1	bronzina/bearing	
357	276.1300.067 DV C 10	1	anello reggispinta/thrust washer	
358	276.4320.021 S 10	1	grano/dowel	
359	276.6130.025 D C	1	perno/gear shaft	
362	9.8965.021 S C 10	1	tappo/plug	
363	9.4670.058 FV C 10	1	guarnizione/copper gasket	
364	9.9730.040 D 10	2	vite/screw M 8 X 1,25 X 80	
366	9.7555.007 DV C 10	2	rondella/washer	
367+374=	=276.3740.032 FVIC	1	FILTRO OLIO COMPLETO OIL FILTER	
368+	832.4730.024 DV C 10	1	guarnizione/gasket	
369	824.6370.187 N A	1	piastra/intermediate plate	
"	673.6370.124 N	1	"	5LD824-3
370	276.4670.014 SV C 10	1	guarnizione/copper gasket	
371+	832.4730.024 DV C 10	1	guarnizione/gasket	
372	9.4670.019 FVBC 10	2	guarnizione/copper gasket	
"	9.4670.022 N A 10	2	"	
373	832.5953.036 DVBC 10	2	nippio/nipple	
"	824.5953.060 N A 10	2	"	
374+	276.2175.036 FVAC	1	cartuccia olio/oil filter element	
377+	9.8965.023 D C 10	1	tappo/plug	
378+	9.4670.058 FV C 10	1	guarnizione/copper gasket	
379+328+381+382=	=276.1526.018 F C =832.1525.096 F C	3 3	BIELLA COMPLETA/CONNECTING ROD x 5LD675-3 x 5LD825-3 - 825-3/L - 930-3	
380				
381+	270.1860.007 FV C 10	6	bullone/bolt	
382+	9.3203.034 FVIC 10	6	dado/nut	
383	291.1640.045 FV C	3	bronz.biella/large end bushing	std.
"	291.1640.048 F CR	3	"	-0,25
"	291.1640.049 F CR	3	"	-0,50
384+	9.9765.009 N 10	1	vite/screw M 8 X 1,25 X 10	
385+	276.4775.080 N 50	1	guarnizione/gasket	
386	822.7301.036 S C 10	1	raccordo/connection	
387	823.6902.036 SV C	1	prolunga/extension	
388+	822.4775.250 DV C 10	1	guarnizione/gasket	

FIG. NO.	MATRICOLA PART NO.	Q.ta Q.ty	NOTE REMARKS	Gr. 5-3 Cyl. Pag.08
389	276.1400.027 F C 10	1	asta livello/dipstick std.	5LD675-3
"	2760.1400.037 D C	1	"	prolungata/extended
"	832.1400.055 F C 10	1	"	std.5LD825-3 -825-3/L
"	8320.1400.060 D C	1	"	prolungata/extended
"	2770.1400.100 N	1	"	X port.prof./deep pan
"	9330.1400.122 D C	1	"	std. 5LD930-3
"	2760.1400.104 N	1	"	X port.prof./deep pan
390+	9.2280.056 FV C 10	1	chiavetta/key	
391+	9.2280.056 FV C 10	1	chiavetta/key	
392+	276.9000.028 F C 10	6	tappo/expansion plug	
393+388=			TAPPO RIFORNIMENTO OLIO	
=822.9032.027 FV C		1	FILLER OIL CAP	
394+390+391+392+395+			ALBERO A GOMITO	
423=			CRANKSHAFT	
=673.1050.189 S C		1	x 5LD675-3	
=823.1050.186 S C		1	x 5LD825-3 - 825-3/L - 930-3	
395+	9.2280.056 FV C 10	1	chiavetta/key	
396	822.1611.078 FV C	1	bronz.1.volano/flywheel side bear.	std.
"	822.1611.062 F CR	1	"	-0,25
"	822.1611.063 F CR	1	"	-0,50
"	822.1611.064 F CR	1	barenabile/bearing reamed	
397+	9.1213.135 FV C	1	anello tenuta/seal ring	
398	9040.6612.064 S AC	1	spia batteria/battery warning	
399+	.....		vedi/see fig.No. 405+...	
400+	5000.9180.056 FVAC 10	4	terminale/faston	
401+	9.2200.002 S C 10	1	chiavetta/key	
402	5000.2118.047 N 10	4	capocorda/cable-end	
403	9.9730.111 N 10	1	vite/screw M 8 X 1,25 X 55	
404	9.7555.007 DV C 10	2	rondella/washer	
405+399+401+406+407+			POMPA OLIO COMPLETA	
446+448=			LUB.OIL PUMP ASS.Y	
=824.6605.051 S C		1	std.	
=824.6605.072 N		1	-1,00	
406+	9.1200.038 FV C 10	1	anello OR/rubber oil seal	
407+	9.9765.055 N 10	1	vite/screw M 12 X 1,25 X 10	
408	9.3260.059 SV C 10	1	dado/nut	
409	276.5111.025 D C 10	1	lamierino/tabwasher	
410	276.4910.019 S	1	ingranaggio/timing gearwheel	
411+	276.1600.055 FVIC	1	bronz.aib.camme/camshaft bearing	std.
"	276.1600.056 F ICR	1	"	-0,25
"	276.1600.057 F ICR	1	"	-0,50
"	276.1600.058 F ICR	1	"	-1,00
"	276.1600.059 F ICR	1	+1,00 su diam.esterno/on ext.diameter	
412	9.1770.005 F 10	2	bullone/bolt M 8 X 1,25 X 22	
413	9.9765.018 D C 10	1	vite/screw M 10 X 1,5 X 16	
414	9.2280.056 FV C 10	1	chiavetta/key	
415	276.5111.007 S C 10	1	lamierino/safety plate	
416	276.6275.057 S C	1	piastra/plate	
417	9.9765.053 D C 10	1	vite/screw M 5 X 0,8 X 10	
418	823.1011.070 S C	1	albero camme/camshaft	
419	9.9027.007 N	1	tappo/plug	
420+	9.8965.021 S C 10	1	tappo/plug	
421+	9.4670.058 FV C 10	1	guarnizione/copper gasket	
422+257+337+338+377+			BASAMENTO COMPLETO	
378+384+411+420+421+			CRANKCASE	
429+473+522+554+706+				
707=				
=823.1510.176 D C		1	x 5LD675-3 - 825-3 - 825-3/L	
=933.1510.179 S C		1	x 5LD930-3	
423+	9.9765.108 N 10	1	vite/screw	
424+425+426+486+488+			SUPPORTO CENTRALE LATO DISTRIB.	
489+490+708+710+711+			GEAR SIDE MIDDLE SUPPORT	
712=				
=672.8660.037 S C		1	x 5LD675-3	
424+425+426+486+488+			SUPPORTO CENTRALE LATO DISTRIB.	
489+490+709+710+711+			GEAR SIDE MIDDLE SUPPORT	
712=				
=823.8660.039 S C		1	x 5LD825-3 - 825-3/L - 930-3	
425+	822.5111.074 DV C 10	2	lamierino/safety plate	
426+	9.1780.029 D C 10	4	bullone/bolt M 10 X 1,5 X 75	
427	832.1257.012 FV C	2	anello reggispinta/thrust washer	

FIG. NO.	MATRICOLA PART NO.	Q.ta Q.ty	NOTE REMARKS	Gr. 5-3 Cyl. Pag.09
428+425+426+486+488+ 489+490+708+710+711+ 712=	=673.8660.038 S C	1	SUPPORTO CENTRALE LATO VOLANO FLYWHEEL SIDE MIDDLE SUPPORT  x 5LD675-3	
428+425+426+486+488+ 489+490+709+710+711+ 712=	=823.8660.040 S C	1	SUPPORTO CENTRALE LATO VOLANO FLYWHEEL SIDE MIDDLE SUPPORT  x 5LD825-3 - 825-3/L - 930-3	
429+ 430	9.6780.015 SV C 10	6	prigioniero/stud M 8 X 21 (40)	
431	9.3203.047 FV C 10	6	dado/nut	
432+	276.2816.010 F C	1	corona avviamento/crown gear	
433+432=	=276.9881.054 S C =2760.9883.093 N	1 1	VOLANO+CORONA/FLYWHEEL+CROWN GEAR std. x 5LD675-3 - 825-3 - 930-3 std. x 5LD825-3/L	
434	9.3240.043 DV C 10	1	dado/nut	
435	9.7701.009 N 10	1	rondella/washer	
436	276.4935.034 S BC	1	ingranaggio/lub.oil pump gearwheel	
"	823.4936.082 N A	1	" "	
437	823.1862.067 N	1	bullone/bolt	
438	9.9730.100 F 10	2	vite/screw M 8 X 1,25 X 25	
439	9.4670.016 FV C 10	1	guarnizione/copper gasket	
440	9.1901.051 FVIC 10	1	bullone raccordo/connection bolt	
441	9.4670.058 FV C 10	1	guarnizione/copper gasket	
442	9.4670.058 FV C 10	1	guarnizione/copper gasket	
443	276.9485.022 S C	1	tubo lubrificazione/lub.oil pipe	
444	9.1901.051 FVIC 10	1	bullone raccordo/connection bolt	
445	9.4670.058 FV C 10	1	guarnizione/copper gasket	
446+	9.9730.026 F 10	2	vite/screw M 8 X 1,25 X 20	
447	9.4670.058 FV C 10	1	guarnizione/copper gasket	
448+	9.7555.007 DV C 10	2	rondella/washer	
449+450+451+452+453+ 454+455+456+457+458+ 459+460+461+508+509+ 510+514+735=	=823.7362.120 S C	1	REGOLATORE DI GIRI COMPLETO SPEED GOVERNOR ASS.Y  std.	
449+450+451+462+463+ 464+465+466+467+468+ 513+515+516+517+518+ 519=	=6720.7362.121 S C	1	REGOLATORE DI GIRI COMPLETO SPEED GOVERNOR ASS.Y  per gruppi elettrog./for generating sets	
449+450=	=276.8590.018 D C	1	SUPPORTO ALBERO REGOLATORE GOVERNOR SHAFT SUPPORT	
450+	276.1702.008 SV C 10	2	bronzina/bearing	
451+	276.1300.074 D C 10	1	anello reggispinta/thrust washer	
452+	9.1240.018 D 10	1	anello seeger/snap ring	
453+	276.2085.041 D	1	campana/governor bell	
454+	823.2471.045 D C	1	collare/collar	
455+	276.5111.022 D C 10	1	lamierino/tabwasher	
456+	276.4130.063 SV C 10	1	ghiera/ring nut	
457+	276.2086.029 D	1	campana/governor bell	
458+	9.1240.007 FV C 10	1	anello seeger/snap ring	
459+	9.3100.032 S C	1	cuscinetto/ball bearing	
460+	276.1160.015 D C 10	1	anello/circlip	
461+	276.6000.042 D C 10	1	pastiglia/drive rod	
462+	276.8365.017 S 10	2	spina/taper pin	
463+	276.8805.005 D C	1	supporto/support	
464+	260.5496.004 SV C	1	massa regolatore/governor weight	
465+	.....		vedi/see fig.No. 449+...	
466+	9.3010.055 N	1	cuscinetto/ball bearing	
467+	276.1160.012 N 10	1	anello/circlip	
468+	.....		vedi/see fig.No. 449+...	
469	276.3206.018 SV C	1	dado/nut	
470	276.5111.004 D C 10	1	lamierino/tabwasher	
471	822.4936.071 F BC	1	ingranaggio/gearwheel	
"	823.4936.080 N A	1	" "	
472	9.6800.055 D C 10	2	prigioniero/stud M 10 X 25 (37)	
473+	822.1611.079 FV C	1	bronz.l.distr./gear side bearing std.	
"	822.1611.070 F CR	1	" " -0,25	
"	822.1611.071 F CR	1	" " -0,50	
"	822.1611.072 F CR	1	barenabile/bearing reamed	
474	9.1770.010 N 10	2	bullone/bolt M 8 X 1,25 X 35	
475	9.7565.011 F C 10	2	rondella/washer	
476	9.3240.033 FV 10	2	dado/nut	

FIG. NO.	MATRICOLA PART NO.	Q.ta Q.ty	NOTE REMARKS	Gr. 5-3 Cy1. Pag. 10
477	276.1970.073 D C 10	2	bussola/sleeve	
478+	276.1862.009 N 10	1	bullone/bolt	
479+	276.5550.015 SV C 10	1	molla/spring	
480+	9.7565.004 F C 10	1	rondella/washer	
481+478+480+531+532+ 533+534= =822.5200.199 S		1	LEVA COMANDO POMPA INIEZIONE INJECTION PUMP CONTROL LEVER	
482	276.2380.090 S C	1	cilindretto/plunger 5LD675-3	
"	276.2380.091 D IC	1	" " 5LD825-3 -825-3/L -930-3	
483	822.1611.061 FV C	2	bronz. supp. centr./middle supp. bear. std.	
"	822.1611.073 F CR	2	" " " -0,25	
"	822.1611.074 F CR	2	" " " -0,50	
"	822.1611.075 F CR	2	barenabile/bearing reamed	
484	9.3240.063 N 10	1	dado/nut	
485+	9.1760.023 N 10	1	bullone/bolt M 6 X 1 X 30	
486+	276.1861.042 F C 10	2	bullone/bolt	
487+	9.1760.028 N 10	1	x 2200-3000 G/1'-R.P.M.- M 6 X 1 X 35	
"	9.1760.041 D IC 10	1	x 1500-1800 G/1'-R.P.M.- M 6 X 1 X 40	
488+	9.7625.020 D C 10	2	rondella/washer	
489+	822.5957.003 SV C 10	2	nottolino/lockpin	
490+	9.7625.026 S 10	2	rondella/washer	
491	9.1901.030 FVIC 10	1	bullone raccordo/connection bolt	
492	9.4670.059 FVIC 10	1	guarnizione/copper gasket	
493	9.4670.059 FVIC 10	1	guarnizione/copper gasket	
494	276.7200.042 SV C 10	1	puntalino/drive rod	
495+	560.4580.047 FVIC 50	1	guarnizione/gasket 1,00	
"	560.4580.049 FV C 10	1	" " 0,50	
"	560.4580.050 FV C 10	1	" " 0,80	
496	276.6585.030 FV C	1	pompa alimentazione/feed pump	
497	9.4670.059 FVIC 10	1	guarnizione/copper gasket	
498	9.4670.059 FVIC 10	1	guarnizione/copper gasket	
499	9.1901.030 FVIC 10	1	bullone raccordo/connection bolt	
503+	822.9455.059 D	1	tubo lubrificazione/lub.oil pipe	
504	9.3260.004 DV C 10	1	dado/nut	
505	276.5111.027 D C 10	1	lamierino/tabwasher	
506	276.4935.037 S	1	ingranaggio/speed governor gearwheel	
507	9.2200.011 D C 10	1	chiavetta/key	
508+	276.1085.004 D C	1	albero/speed governor shaft	
509+	276.1300.073 D C 10	1	anello reggispinta/thrust washer	
510+	9.2200.010 D 10	1	chiavetta/key	
511	9.1770.004 F C 10	2	bullone/bolt M 8 X 1,25 X 20	
512	9.7565.007 F C 10	2	rondella/washer	
513+	9.1240.018 D 10	1	anello seeger/snap ring	
514+	9.8245.017 S 10	8	sfera/ball	
515+			vedi/see fig.No. 449+...	
516+	276.5168.015 N 10	1	lamierino/spacer 0,20	
"	276.5168.016 N 10	1	" " 0,30	
"	276.5168.017 N 10	1	" " 0,50	
517+	260.5496.004 SV C	1	massa regolatore/governor weight	
518+	260.6330.018 D C	2	piastina/safety plate	
519+	9.1755.002 D 10	4	bullone/bolt M 5 X 0,8 X 12	
520+	822.4560.017 DV C 10	1	guarnizione/gasket	
521	822.2615.037 D C	1	coperchio/cover	
522+	9.9765.104 D C 10	2	vite/screw	
523	822.4670.051 DV C 10	1	guarnizione/copper gasket	
524	276.5111.008 DV C 10	1	lamierino/safety plate	
525	9.1200.034 FV C 10	1	anello OR/rubber oil seal	
526	276.1930.034 D C 10	1	bullone/bolt	
527	673.3740.057 D C	1	filtro olio/oil filter std. 5LD675-3	
"	823.3740.054 D C	1	" " std. 5LD825-3 -825-3/L	
"	9330.3740.062 D C	1	" " std. 5LD930-3	
"	933.3740.060 N	1	" X port.prof./deep pan (mm 180)	
528	276.6428.028 D C	4	piede mot./engine mount 5LD675-3	
"	832.6428.039 S C	4	" " 5LD825-3 -825-3/L -930-3	
529	9.7565.013 S C 10	12	rondella/washer std.	
"	9.7626.018 N 10	1	rondella per fissaggio staffa marmitta washer for muffler bracket fixing	
530	9.1790.025 F C 10	12	bullone/bolt M 12 X 1,25 X 30	
"	9.1790.026 D C 10	1	bull fiss.staffa marmitta-M 12X1,25X35 bolt for muffler bracket fixing	
531+	276.5270.081 D C 10	1	leva/lever	
532+	9.1240.002 SV 10	1	anello seeger/snap ring	
533+	9.7625.010 FV C 10	1	rondella/washer	
534+	822.6110.075 D C	1	perno/pin	
535+	904.5655.046 FVIC 10	1	molla/spring 1500-1800 G/1'- R.P.M.	
"	904.5655.048 SV C 10	1	" " 2200-3000 G/1'- R.P.M.	
536+	276.5270.045 N 10	1	leva/lever	
537+	9.8430.023 S C 10	1	spina/locating pin	
538+	9.3240.008 FV 10	1	dado/nut	
539+	276.1970.071 N 10	2	bussola/sleeve	

FIG. NO.	MATRICOLA PART NO.	Q.ta Q.ty	NOTE REMARKS	Gr. 5-3 Cy1. Pag. 11
540+	9.3240.008 FV	10	1	dado/nut
541+	9.7555.004 FV C	10	2	rondella/washer
542+	9.1200.001 FV C	10	1	anello OR/rubber oil seal
543	.....			
544+	9.1770.001 FV	10	1	bullone/bolt M 8 X 1,25 X 12
545+	276.6141.021 N		1	perno/pin
546+	276.5680.040 S C	10	1	molla/spring
547+	9.1760.001 FV	10	1	bullone/bolt M 6 X 1 X 10
548+	.....			vedi/see fig.No. 646+...
549+	276.5680.053 S C	10	1	molla/spring
550+	276.6141.023 D C	10	1	perno/pin
551+548+549+550+552+				COMANDO A MANO
553+603+604+605+606+				HAND CONTROL
643+644+645+646=				
=276.2515.070 F C			1	std.
552+	276.5201.005 S		1	leva/lever
553+	9.8430.023 S C	10	1	spina/locating pin
554+	9.6780.007 S	10	2	prigioniero/stud M 8 X 20 (32)
555	.....			
556	9.3203.047 FV C	10	2	dado/nut
557+	9.1202.017 FV C	10	1	anello OR/rubber oil seal
558	9.9730.026 F	10	4	vite/screw M 8 X 1,25 X 20
559+503+557+560+561+				KIT PREDISPOSIZ.POMPA OLEODINAMICA
562+563+564+565+568+				HYDRAULIC PUMP ADAPTER
570+572+573+607+608+				
610+611+732+752=				
=8220.8888.377 S *			1	2 PD 3. PRESA MOTO - P.T.O.
559+	276.3780.036 S		1	flangia/flange
560+	9.1202.037 D	10	1	anello OR/rubber oil seal
561+	9.1240.016 D	10	1	anello seeger/snap ring
562+	276.1300.070 S		1	anello reggispinta/thrust washer
563+752=				
=822.4936.059 S C			1	INGRANAGGIO PREDISPOSIZIONE
				HYDRAULIC PUMP ADAPTER GEARWHEEL
564+	9.8430.061 D	10	1	spina/locking needle
565+	822.1300.102 D	10	1	anello/ring
566	.....			
567	9.6800.005 D C	10	2	prigioniero/stud M 10 X 26 (35)
568+	822.6130.055 S C		1	perno/gear shaft
569	9.7565.011 F C	10	2	rondella/washer
570+	9.4670.058 FV C	10	1	guarnizione/copper gasket
571	9.3240.033 FV	10	2	dado/nut
572+	9.4670.058 FV C	10	1	guarnizione/copper gasket
573+	9.1901.048 FVIC	10	1	bullone raccordo/connection bolt
574	9.9731.092 S	10	4	vite/screw M 8 X 1,25 X 14
575	9.8430.038 D C	10	4	spina/locking needle
576+	9.1210.087 FV C	10	1	anello tenuta/seal ring
577+	276.4680.037 N	50	1	guarnizione/gasket
578+	277.4600.094 SV C	10	1	guarnizione/gasket
579	9.1770.002 FV	10	1	bullone/bolt M 8 X 1,25 X 16
580	9.7625.012 FV C	10	1	rondella/washer
581+	276.1580.046 D BC	10	1	boccola/bushing
"	276.1580.119 S AC	10	1	" "
582+	276.5600.022 SV C	10	1	molla/spring
583+	9.7625.070 D C	10	1	rondella/washer
584+	9.6000.021 F C	10	1	pastiglia/nut
585+	9.9790.023 F C	10	1	vite/screw M 5 X 0,8 X 7
586+581+582+583+584+				COMANDO A DISTANZA
585+587+588+636+637+				REMOTE CONTROL
638+639+640+643+644=				
=276.2515.071 F C			1	std.
586+	2760.2690.076 D C		1	coperchio/housing cover
587+	9.3240.019 FV C	10	1	dado/nut
588+	2760.9180.042 S C	10	1	terminale/cable-end
589+	276.4680.036 DV C	50	1	guarnizione/gasket
590+478+479+480+481+				SCATOLA REGOLATORE COMPLETA
485+487+531+532+533+				GOVERNOR HOUSING ASS.Y
534+535+536+537+538+				
539+540+541+542+544+				
545+546+547+591+592+				
593+594+595+596+597+				
599+600+601+602+641+				
642+713+753+754=				
=822.7865.085 F C			1	std.

FIG. NO.	MATRICOLA PART NO.	Q.ta Q.ty	NOTE REMARKS	Gr. 5-3 Cyl. Pag. 12
591+	9.1760.007 S	10	2	bullone/bolt M 6 X 1 X 25
592+	9.1200.081 D	10	1	anello OR/rubber oil seal
593+	9.3000.004 S C		1	cuscinetto/ball bearing
594+	9.4445.003 SV C	10	1	guarnizione/gasket
595+592+593+594+641+713=	=822.8615.083 S		1	SUPPORTO PERNO COMPLETO JOURNAL SUPPORT ASS.Y
596+	276.5270.082 S C		1	leva/lever
597+	9.8430.005 D C	10	1	spina/locating pin
598				
599+	9.6760.004 D	10	2	prigioniero/stud M 6 X 14 (23)
600+	9.7625.059 D C	10	2	rondella/washer
601+	9.3240.008 FV	10	2	dado/nut
602+	9.8420.002 S C	10	1	spina/locating pin
603+	9.8430.023 S C	10	1	spina/locating pin
604+	9.7625.007 S C	10	1	rondella/washer
605+	9.3200.015 FVIC	10	1	dado/nut
606+	9.1165.001 S	10	1	anello/circlip
607+	9.1202.036 D	10	1	anello OR/rubber oil seal
608+	2760.1301.082 D	10	1	anello riduzione/reduction ring
609	276.4601.046 S	10	1	guarnizione/gasket
610+	276.8060.022 F C		1	semigiunto/half-coupling
611+	2760.4240.028 F C		1	giunto/coupling
612	9.9730.026 F	10	3	vite/screw M 8 X 1,25 X 20
613	822.6685.057 S C		1	portina/pan
614+	276.4601.046 S	10	1	guarnizione/gasket
615	9.3260.057 SV C	10	1	dado/nut
616	276.7530.020 S C	10	1	rondella/washer
617	822.5885.047 S C		1	mozzo/hub
618	823.6975.111 S C		1	puleggia/fan driving pulley Diam.=193
619	9.9730.009 D	10	3	vite/screw M 6 X 1 X 12
620	9.7555.004 FV C	10	3	rondella/washer
621	276.2615.018 S C		1	copercchio/cover
622+	276.4431.013 D	10	1	guarnizione/gasket
623	9.9732.092 F C	10	12	vite/screw M 8 X 1,25 X 18
624+576=	=822.2690.142 S C		1	COPERCHIO SCATOLA INGRANAGGI GEAR TIMING HOUSING COVER
625+	276.8460.055 D C	10	2	spina/taper pin
626+	276.4431.006 SV C	10	1	guarnizione/gasket
627+155+625=	=822.7885.022 D C		1	SCATOLA INGRANAGGI GEAR TIMING HOUSING
628	9.1770.006 S	10	9	bullone/bolt M 8 X 1,25 X 25
629	9.7555.007 DV C	10	12	rondella/washer
630	9.7625.010 FV C	10	14	rondella/washer
631	9.1770.004 F C	10	12	x 5LD675-3,825-3,825-3/L-M 8 X 1,25 X 20
"	9.1770.006 S	10	14	x 5LD930-3 - M 8 X 1,25 X 25
632+633+634=	=277.6645.119 D C		1	PORT.FONDO/OIL PAN std. 5LD675-3
	=833.6645.121 D C		1	" " std. 5LD825-3 -825-3/L
632	933.6647.084 D C		1	port.fondo/oil pan std. 5LD930-3
"	2770.6645.091 D C		1	portina profonda/deep oil pan (mm 180)
633+	9.4670.016 FV C	10	1	guarn./cop.gask. 5LD675-3 -825-3 -825-3/L
			2	5LD930-3
634+	9.8965.005 FV C	10	1	tappo/oil plug 5LD675-3 -825-3 -825-3/L
			2	5LD930-3
635	9.1770.002 FV	10	2	bullone/bolt M 8 X 1,25 X 16
636+	276.5200.287 S AC		1	leva/lever
637+	90.6000.031 FV C	10	1	pastiglia/nut
638+	9.9790.023 F C	10	1	vite/screw M 5 X 0,8 X 7
639+	9.3240.009 FV C	10	1	dado/nut
640+	70.9180.011 S C	10	1	terminale/cable-end
641+	9.3000.004 S C		1	cuscinetto/ball bearing
642+	822.5200.172 S C		1	leva/lever
643+	9.7565.004 F C	10	4	rondella/washer
644+	9.1760.010 N	10	4	bullone/bolt M 6 X 1 X 30
645+	276.2135.056 N	10	1	cappuccio/cap
646+548=	=276.5200.244 D IC		1	LEVA COMANDO STOP STOP CONTROL LEVER
647+	9.7555.004 FV C	10	6	rondella/washer
648+	9.1760.005 FV	10	6	bullone/bolt M 6 X 1 X 16
649	9.7555.007 DV C	10	2	rondella/washer
650	9.9730.026 F	10	2	vite/screw M 8 X 1,25 X 20



FIG. NO.	MATRICOLA PART NO.	Q.ta Q. ty	NOTE REMARKS	Gr. 5-3 Cyl. Pag. 13
651+	6720.4570.008 DV C 50	3	guarnizione/gasket	
652	933.7100.155 D C	1	puleggia/external alternator pulley	
653	2760.9718.035 D C	1	ventola alternatore/alternator fan	
654	2760.1157.046 FVIC	1	altern.esterno/volt.alternator 12 V-33 A	
655	9.1770.039 S C 10	1	bullone/bolt M 8 X 1,25 X 28	
656	9.7625.059 D C 10	7	rondella/washer	
657	673.5066.052 D C	1	lamiera/panel 5LD675-3	
"	823.5066.049 D C	1	" " 5LD825-3 -825-3/L -930-3	
658	823.5066.043 D C	1	lamiera intermedia/middle panel	
659	823.5066.045 D BC	1	lamiera inferiore/lower panel	
"	823.5066.164 N A	1	" " " "	
"	821.5066.162	1	" " " " 5LD824-3	
661	9.1770.002 FVB 10	4	bullone/bolt M 8 X 1,25 X 16	
662	9.1770.005 F 10	2	bullone/bolt M 8 X 1,25 X 22	
663	9.7500.013 D BC 10	2	rondella/washer	
664	823.8546.074 D BC	1	staffa radiatore/oil cooler brace	
665	823.8546.073 D BC	1	staffa radiatore/oil cooler brace	
666	673.9485.072 S C	1	tubo olio per motore senza radiatore	
"	823.9485.070 S BC	1	oil pipe for engine without oil cooler	
666a	823.9485.120 N A	1	tubo olio per motore con radiatore	
667	823.4115.051 D C 10	2	oil pipe for engine with oil cooler	
668	9.9732.075 S C 10	4	gancio/hook	
669	9.1770.001 FV 10	2	vite/screw M 8 X 1,25 X 50	
670	9.7565.007 F C 10	2	bullone/bolt M 8 X 1,25 X 12	
671	673.6975.109 D C	1	rondella/washer	
"	823.6975.110 S C	1	x 5LD675-3 Diam.=97 R.P.M.=5969-3000/'	
"	933.6975.117 D C	1	x 5LD825-3 Diam.=84 R.P.M.=5973-2600/'	
"	277.6975.144 N	1	x 5LD825-3/L " R.P.M.=5054-2200/'	
			x 5LD930-3 Diam.=77 R.P.M.=6516-2600/'	
			x 5LD825-3/L Diam.=64 R.P.M.=5428-1800/'	
			x 5LD825-3/L " R.P.M.=4523-1500/'	
			x 5LD930-3/L " R.P.M.=5428-1800/'	
			x 5LD930-3/L " R.P.M.=4523-1500/'	
672	904.3526.055 S C	1	distanziale/spacer	
673+	6720.6300.020 D C	3	piastrina/plate	
674	823.6927.070 D C	1	protezione cinghie/belt guard std.	
"	933.6927.080 S C	1	protezione cinghie per alternat.esterno	
675	9.9730.110 D C 10	2	belt guard for external volt.alternator	
676+	9.1780.066 N 10	1	vite/screw M 6 X 1 X 60	
677+	823.7051.061 D C	1	bullone/bolt M 10 X 1,5 X 70	
678+	823.3466.037 D C	1	puleggia galoppino/jockey pulley	
679+	823.7500.025 N 10	1	distanziale/spacer	
680+	9.7565.011 F C 10	1	rondella/washer	
681+	9.3240.033 FV 10	1	rondella/washer	
682+	823.6231.053 D C	1	dado/nut	
683	9.3240.033 FV 10	1	perno/pin	
684	9.6800.004 F 10	1	dado/nut	
685	9.7565.011 F C 10	1	prigioniero/stud M 10 X 20 (35)	
686	9.7625.196 N 10	1	rondella/washer	
687	9.3240.033 FV 10	1	rondella/washer	
688	9.6800.004 F 10	1	dado/nut	
689	9.7565.011 F C 10	1	prigioniero/stud M 10 X 20 (35)	
690	9.7625.196 N 10	1	rondella/washer	
691+676+677+678+679+			TENDICINGHIA COMPLETO	
680+681+682+718+719+			JOCKEY PULLEY ASS.Y	
720=	=823.4110.006 S C	1	std.	
691+	823.6360.055 D C	1	piastra/plate	
692	9.7625.061 D C 10	2	rondella/washer	
693	9.1760.001 FV 10	1	bullone/bolt M 6 X 1 X 10	
694	9.1760.001 FV 10	1	bullone/bolt M 6 X 1 X 10	
695	9.7625.061 D C 10	2	rondella/washer	
696	9.1770.005 F 10	2	bullone/bolt M 8 X 1,25 X 22	
697	673.5390.014 N	1	manicotto/sheat 5LD675-3	
"	823.5390.013 D BC	1	" " 5LD825-3 -825-3/L -930-3	
697a	823.5401.073 N A	1	" " " "	
"	821.5401.098 N	1	" " 5LD824-3	
698	673.5140.011 N	1	lamiera/brace 5LD675-3	
"	823.5140.010 D BC	1	" " 5LD825-3 -825-3/L -930-3	
699	9.3240.018 FV 10	1	dado/nut	
700	9.6780.045 S 10	.	prigioniero (1 pz. fino a .../3 pz. da...)	
701	9.7565.007 F C 10	.	stud (1 piece up to.../3 pieces from...)	
702+	824.4701.055 FV C 10	1	rondella (1 pz. fino a.../3 pz. da...)	
703	824.8636.028 SV C	1	washer (1 piece up to.../3 pieces from...)	
704+	824.4701.055 FV C 10	1	guarnizione/gasket	
			supporto antivibr./vibration isolator	
			guarnizione/gasket	

FIG. NO.	MATRICOLA PART NO.	Q.ta Q.ty	NOTE REMARKS	Gr. 5-3 Cyl. Pag. 14
705	9.3240.018 FV	10	8	dado/nut
706+	823.4160.011 SV C	10	1	ghiera/ring nut
707+	9.4670.016 FV C	10	1	guarnizione/copper gasket
708+	277.8980.025 FV C	10	3	tappo/plug 5LD675-3
709+	823.8485.001 DV C		3	spruzz./oil sprayer 825-3 -825-3/L -930-3
710+	9.1790.051 D C	10	2	bullone/bolt M 12 X 1,75 X 95
711+	822.5957.011 DV C	10	2	nottolino/lockpin
712+	9.7565.013 S C	10	2	rondella/washer
713+	822.3512.011 D C	10	1	distanziale/spacer
714	9.9730.031 D C	10	1	vite/screw M 8 X 1,25 X 40
715	9.7565.011 F C	10	2	rondella/washer
716+	2760.5200.190 D C		1	leva/lever
717+	2760.6095.011 D C		1	perno/decompression shaft
718+	823.7670.095 N	10	1	rondella/washer
719+	9.1240.051 DV C	10	1	anello seeger/snap ring
720+	823.3010.095 S C		1	cuscinetto/ball bearing
721	9.7625.061 D C	10	1	rondella/washer
722	9.3240.018 FV	10	1	dado/nut
723	9.1770.056 S C	10	1	bullone/bolt M 8 X 1,25 X 18
724	9.7565.007 F C	10	1	rondella/washer
725	360.8546.048 D C		1	staffa/brace
726	9.7565.007 F C	10	2	rondella/washer
727	933.2501.031 D C		1	colonna/hollowstud
728	9.3240.018 FV	10	4	dado/nut
729	9.7565.007 F C	10	4	rondella/washer
730	9.6780.012 DV C	10	4	prigioniero/stud M 8 X 25 (37)
731	933.8903.090 D C		1	supporto/alternator support
732+	9.1201.083 D	10	1	anello/ring
733	276.1970.084 N	10	2	bussola/sleeve
734	9.7555.007 DV C	10	2	rondella/washer
735+	9.9765.009 N	10	1	vite/screw M 8 X 1,25 X 10
737	672.7625.100 S AC	10	12	rondella/washer
738	672.5801.135 SVAC	10	6	molla/spring
739+	3600.6491.013 FVAC		1	pipetta/pipe elbow
740	9040.2900.069 F C		1	cruscotto/dashboard
741	9040.2900.070 F C		1	cruscotto/dashboard
742	3600.2900.071 D C		1	cruscotto/dashboard
743	3600.2900.072 S C		1	cruscotto/dashboard
744	2760.2750.111 F C		1	coperchio/switch cover
745	2760.5450.009 FV C		1	manometro olio/pressure oil gauge
746	9040.7195.056 SV C		1	pulsante/push-button
747	9.1901.055 FVIC	10	1	bullone raccordo/connection bolt
748	2920.9475.034 S C		1	tubo manometro/gauge pipe mm 2000
"	2760.9475.035 N		1	" " mm 4000
749+274+275+277+333+				FILTRO ARIA CON PREFILTRO A CICLONE
750=				AIRCLEANER CYCLONIC TYPE
	-822.3703.056 DV C		1	
750+	276.6727.015 FV C		1	prefiltro/cyclonic prefilter
751	9.7625.061 D C	10	2	rondella/washer
752+	276.1685.023 DV C		2	bronzina/bearing
753+	9.3240.008 FV	10	1	dado/nut
754+	9.9765.122 N	10	1	vite/screw M 6 X 1 X 30
770	9.1901.040 SVAC	10	1	bullone raccordo/connection bolt
771	9.4670.060 FVAC	10	1	guarnizione/copper gasket
772	9.4670.060 FVAC	10	1	guarnizione/copper gasket
773	824.5953.060 N A		2	nipplo/nipple
774	9.4670.022 N A	10	2	guarnizione/copper gasket
775	9.3240.033 FVA	10	2	dado/nut
776	9.7625.020 S AC	10	2	rondella/washer
777	9.1780.015 FVA	10	2	bullone/bolt
778	824.4775.255 N A		1	guarnizione/rubber gasket
779	824.8545.130 N A		1	staffa/brace
780	823.8545.138 N A		1	staffa/brace
781	823.4936.081 N A		1	ingranaggio/gearwheel
782	9.3240.020 SVAC	10	2	dado/nut
43+121+174+180+188+				SERIE GUARNIZIONI
220+270+297+335+368+				GASKET SET
371+385+495+520+577+				
578+589+614+622+626+				
651+702+704=				
	=673.8180.067 FV CR		1	x 5LD675-3
	=823.8180.064 FV CR		1	x 5LD825-3 - 825-3/L
	=933.8180.069 SV CR		1	x 5LD930-3
TECO/ATL				DESCRIZIONI NON IMPEGNATIVE
*****				SUBJECT TO MODIFICATIONS
* 15.03.1989 *				
*****				

MATERIALE DI RETTIFICA  
GRINDING WORKSHOP PARTS LIST  
MATERIEL POUR RECTIFIEUR

Gr. 5-3 Cy1.  
Pag. 15

MOTORI-ENGINES-MOTEURS GR. 5/3 Cy1.

FIG. NO.	MATRICOLA PART NO.	Q.ta Q.ty	NOTE REMARKS
45+	276.4845.164 FVICR10	3	guida v.scar./exh.v.guide std.
"	276.4845.165 FVICR10	3	" " " +0,50
46+	276.4845.162 FVICR10	3	guida v.asp./inlet v.guide std.
"	276.4845.163 FVICR10	3	" " " +0,50
173+	672.8000.075 FV CR10	3	sede v.scar./exh.v.seat 5LD675-3
"	822.8000.073 FV CR10	3	" " 5LD825-3 -825-3/L -930-3
175+	672.8000.074 FV CR10	3	sede v.asp./inlet v.seat 5LD675-3
"	822.8000.072 FV CR10	3	" " 5LD825-3 -825-3/L -930-3
211+	276.9685.019 FV CR10	3	valvola scar./exh.valve 5LD675-3
"	822.9685.053 FV CR10	3	" " 5LD825-3 -825-3/L -930-3
212+	276.9652.015 FV CR10	3	valvola asp./inlet valve 5LD675-3
"	822.9652.041 FV CR10	3	" " 5LD825-3 -825- /L -930-3
271+	276.8210.053 F CR10	3	+0,50 x 5LD675-3 serie segm./ring set
"	276.8210.054 F CR10	3	+1,00 " " " "
"	832.8210.068 F CR10	3	+0,50 x 5LD825-3 - 825-3/L " "
"	832.8210.069 F CR10	3	+1,00 " " " "
"	933.8211.015 F CR10	3	+0,50 x 5LD930-3 " "
"	933.8211.016 F CR10	3	+1,00 " " " "
327+271+329+330=			PISTONE COMPLETO/PISTON SET
=672.6500.156 F CR		3	+0,50 x 5LD675-3
=672.6500.157 F CR		3	+1,00 " " " "
=822.6500.155 F CR		3	+0,50 x 5LD825-3 - 825-3/L
=822.6500.158 F CR		3	+1,00 " " " "
=933.6500.160 F CR		3	+0,50 x 5LD930-3
=933.6500.161 F CR		3	+1,00 " " " "
328+	270.1630.006 FV CR10	3	br.piede biella/small end bear. 5LD675-3
"	832.1630.011 FV CR	3	" " 5LD825-3 -825-3/L -930-3
383	291.1640.048 F CR	3	bronz.biella/large end bushing -0,25
"	291.1640.049 F CR	3	" " " -0,50
396	822.1611.062 F CR	1	bronz.l.volano/flywheel side bear. -0,25
"	822.1611.063 F CR	1	" " " -0,50
"	822.1611.064 F CR	1	barenabile/bearing reamed
411+	276.1600.056 F ICR	1	bronz.alb.camme/camshaft bearing -0,25
"	276.1600.057 F ICR	1	" " " -0,50
"	276.1600.058 F ICR	1	" " " -1,00
"	276.1600.059 F ICR	1	+1,00 su diam.esterno/on ext.diameter
473+	822.1611.070 F CR	1	bronz.l.distr./gear side bearing -0,25
"	822.1611.071 F CR	1	" " " -0,50
"	822.1611.072 F CR	1	barenabile/bearing reamed
483	822.1611.073 F CR	2	bronz.supp.cent./middle supp.bear. -0,25
"	822.1611.074 F CR	2	" " " -0,50
"	822.1611.075 F CR	2	barenabile/bearing reamed
43+121+174+180+188+			SERIE GUARNIZIONI
220+270+297+335+368+			GASKET SET
371+385+495+520+577+			
578+589+614+622+626+			
651+702+704=			
=823.8180.064 FV CR		1	x 5LD825-3 - 825-3/L
=673.8180.067 FV CR		1	x 5LD675-3
=933.8180.069 SV CR		1	x 5LD930-3